

## Tips, advice and care

Whenever you dress up in this clothing, avoid any unnecessary stretching or pulling of the material in order not to damage the internal wiring system.

### IMPORTANT INFORMATION Battery

- To ensure maximum battery longevity it must be completely charged and discharged during the first 8-10 times.
- Consequently, any new battery should never be used until it has been completely charged.
- Strip the battery from the clothing when no longer required.
- Li-on batteries discharges over time - about 5 months.
- Make sure that the battery is always fully charged before storage or use.

### Charger

- For proper and safe charging always observe that only the supplied Nordic Heat charger and battery are used.
- Red light= charging,  
Green light= fully charged.

### Storage

- Always charge the battery before storing - long lasting storage requires the battery to be charged fully. Recharge at least twice yearly.

- Always store in a cool, and dry place, away from sources of strong heat or open fire.
- Li-on batteries, like any other battery will in time also undergo reduction of charging capacity. However, the batteries in question have been tested to last +500 charging cycles.

### Wash & Care

- Spot clean followed by hang-drying.
- Machine wash 30° gentle cycle using washbag with light spin only.
- Alternatively, hand wash followed by hang drying.
- No fabric softener.
- No wringing or twisting of the clothes.
- Always remove battery before washing.

### Safety Warnings

- The clothes are not to be worn in a wet condition.
- For the safety and protection of the electronic parts, needles or pointed objects are not to be inserted in the clothes.
- Keep clothes away from open fires or excessive heat.
- When you remove the battery from the pocket, grab the plug and turn it clock- and counterwise while pulling slightly, avoid pulling the cord.

### Warranty

- Subject to normal usage, Nordic Heat™ extends an all-inclusive 2-year warranty covering clothing and battery. This warranty, however, cannot be transferred. Damage to fabric, wiring connections, or battery by misuse, accidents, fire, water, any unauthorized service or negligence is not covered.
- All repairs must be executed by Nordic Heat™ Service Center, which invite you always to telephone ahead with your problem. Should Customer Service be unable to solve the matter on the telephone, the items in questions are to be forwarded to the Service Center.
- In case of Warranty termination, Nordic Heat reserves the right to charge you for cost of repair and return shipment expenses.
- We kindly suggest you keep the covering invoice for proof of warranty.

## Congratulations on your Nordic Heat™ product

### IMPORTANT!

#### Storage and use of Nordic Heat Lithium-ion batteries

NEVER turn on the product - before a complete charging cycle.

When charging, the light is red and turns green when fully charged.

Whenever the products are to be stored during the summer, make sure that everything is fully charged beforehand. Once again when the season starts and resumption is desired, it is imperative that the batteries should be fully charged before use - This will maintain battery memory, extend the durability and provide you maximum capacity.

### Nordic Heat™ – Product optimization

**Products:** Generally turn on the heating PRIOR being cold, because the technology is basically designed to keep you warm, and not for warming up.

**Gloves:** It is beneficial to switch the setting to RED for a few minutes before going outside and then reducing to yellow or green. This will help prolong the battery life significantly. Warm hands in heated gloves - is the best starting point.

Enjoy your Nordic Heat™ product.



**NORDIC HEAT™**  
STAY WARM AND FOCUSED



# User manual - Nordic Heat™ battery heated 2in1 jacket

Charge battery before use

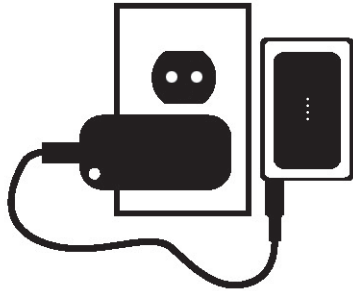

Red light – Charging

Green light – Fully charged.



Internal battery pocket

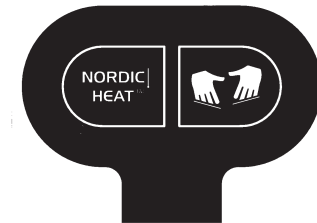

The easy accessible control button manages the on / off function and the desired heat level.

To turn on / off, press lightly and hold down the button for 3 seconds

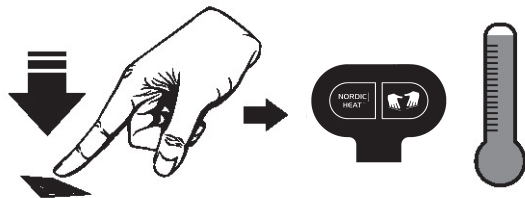

When the clothing is turned on, it starts up at red light, to change temperature, simply press lightly on the button

Red light



High

1 ½ hour

White light



Medium

Heating time approx.:

3 ½ hour

Green light



Low

5 ½ hour